

## Very Easy connection for PC's and Game machines!

The compact 11n high-speed wireless LAN router "MZK-WNH" which realizes Draft2.0 environment 11n of high speeds of a maximum of 150 Mbps is put on the market.

PLANEX Communications, Inc. (CEO: Katsuaki Kubota, The head office: Shibuya-ku, Tokyo) has announced the release of 11n Draft2.0. This product has an Internet connectivity setup and a wireless LAN setup, which can perform better than before by utilizing newly developed, easy-set up Navigation and WPS. This product will be put on the markets at the end of December.

### [Special Features]

- Execution speed of wireless-communications maximum speed 96.8Mbps\*.

With a high speed of 96.8Mbps, users can transfer large files, data and media without frustration.

\* Look at here for Measurement environment <http://www.planex.net/product/router/mzk-wnh.htm>

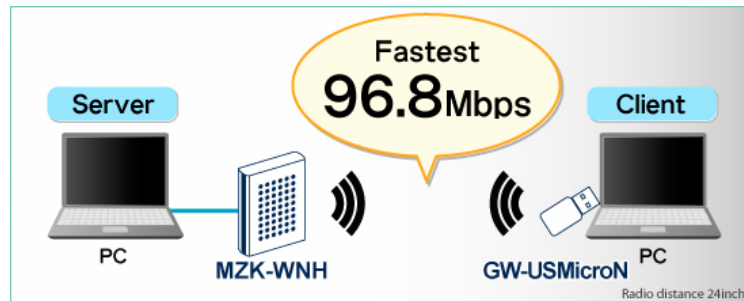

- Upgraded "Easy-set up navigation" is available.

Sometimes setting up network products are confusing and frustrating. This product is easy to install from connecting to the modem all the way to securing an Internet connection. Set up is quick, easy and headache free.

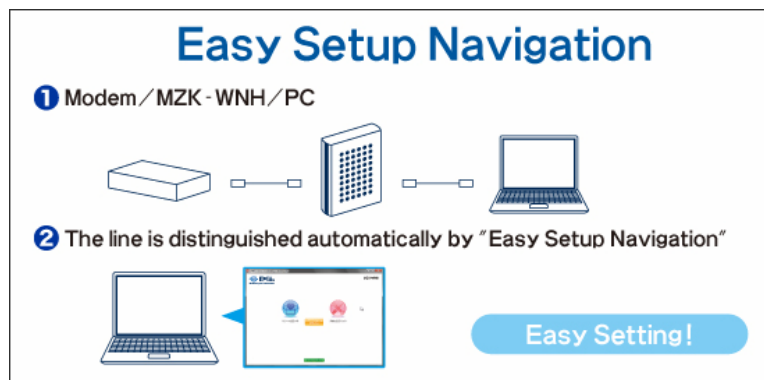

### \*OS

Windows Vista / XP(SP2 later) / 2000(SP4 later)

MAC OSX 10.4 / 10.5(10.4.11 later 10.5.2 later)

## ▶ OPTIMUS (THAILAND) CO., LTD.

49/6 Soi Boonchusri, Dindaeng Rd., Samsennai, Phayathai, Bangkok 10400

Tel : 0-2247-9898 Fax : 0-2245-1166

<http://www.planex.co.th>

- Support WPS

Easy set up for PC beginners for establishing a wireless connection. All that is needed is a push on the WPS button, a gaming system, or a wireless LAN handset. Set up is very easy.

\*The wireless LAN's base unit and the cordless handset need to support WPS.

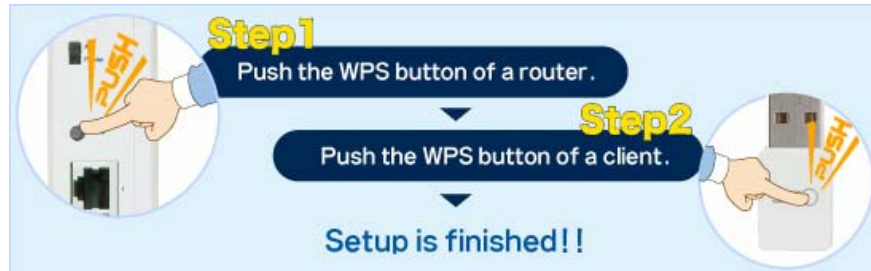

- A simple and compact

The modern, streamline design features a built in antenna to achieve a compact design without compromising the reception quality. Product dimensions are: 34mm (width) x 161mm (depth) x 114mm (height).



- Works with IEEE802.11n Draft2.0.

This router works with IEEE802.11n Draft2.0 along with other next-generation high-speed wireless LANs with speeds of up to a maximum of 150Mbps (theoretical value). Strong and stable connections remain strong up close or from far and distant places where normally other products would be weak and unstable due to distance away from the router or because obstacles in the way.

\*In order to communicate by IEEE802.11n Draft2.0 standard, all devices need to support IEEE802.11n Draft2.0.

- Works with the IEEE802.11b/g wireless standard.

The IEEE802.11b/g radio standard is also supported. It is possible to simultaneously connect to a personal computer as well as other personal computers that are all working with the IEEE802.11n Draft2.0 standard.

### ▶ OPTIMUS (THAILAND) CO., LTD.

49/6 Soi Boonchusri, Dindaeng Rd., Samsennai, Phayathai, Bangkok 10400  
Tel : 0-2247-9898 Fax : 0-2245-1166  
<http://www.planex.co.th>

- Simultaneous connection of the machinery that the security levels which setup is possible is different from is possible.

This router can conform to many security levels. For example, video games require different security measures. As do PCs. This router can connect and conform to all of your security needs.

\*Up to four wireless LAN networks (SSID) can be set.

- A router / with an access point functional changeover switch

It can be used by the router functional existence of a modem, being able to change to a router or an access point function, and can use by almost all providers. Not only can this product be a router, but with a flip of a switch the router can be changed to an access point function and can be used by almost all providers.

- IPv6 bridge functional loading

The IPv6 bridge function of various services can be used along with IPv6.

- RoHS correspondence

Throughout the life cycle of this product, from production to scrap, this product supports RoHS, which is to limit the usage of harmful substances such as lead, cadmium, liquid silver, hexavalent chrome, polybrominated biphenyl, Polybrominated diphenyl ether.